

LTRS	REVISIONS			
ORIGINATOR	REVIEWER	ENGR APP	MATL APP	
FOR RFQ ONLY	N/A	20250918		
EMYCKA	FDOUDA	MWLOCH	JJASINSK	

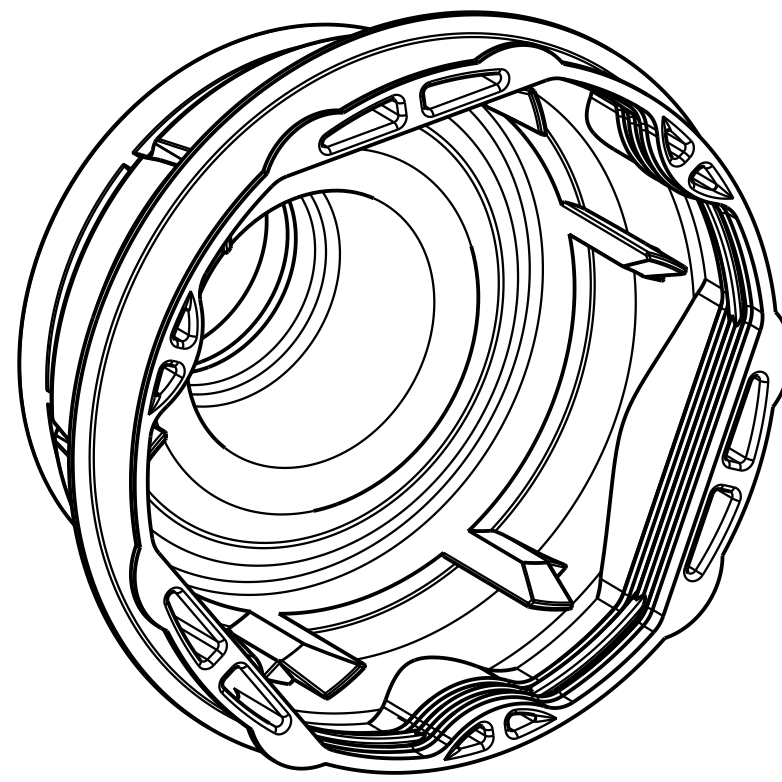

SCALE: 1:1

POTENTIAL SIGNIFICANT CHARACTERISTIC	
1	1.2 ±0.1
2	Ø31.5 ±0.2
3	Ø85.4 ±0.2
4	1.6 ±0.2
5	1.9 ±0.2
6	HYTREL 8745

**DRAFT**  
NOT RELEASED  
Name emycka  
Creation Date: 2025-09-18 10:12:58

- 1 ALL FORMS PERMISSIBLE IN THIS AREA  
2 MARKING:  
- [A], [B], [C]  
- NEAPCO CODE / PART NUMBER  
- MATERIAL RECYCLING MARK: >TPC-ET<  
- PRODUCTION DATE  
- MOULD CAVITY

6 MATERIAL: HYTREL 8745

WEIGHT: 49.6 ±3g

ALL UNDEFINED DIMENSIONS TO BE TAKEN FROM 3D MODEL

DIMENSIONS WITHOUT TOLERANCES ACC. TO ISO 3302-1 M3 F

WALL THICKNESS RADIAL VARIATION NOT TO BE GREATER THAN 0.25mm.

CHANGES AFFECTING DESIGN, SPECIFICATION, MATERIAL SOURCE OR PRODUCTION PROCESS OF THE PART PREVIOUSLY APPROVED BY NEAPCO REQUIRE PRIOR APPROVAL FROM NEAPCO REFER TO IATF 16949 NEAPCO CUSTOMER SPECIFIC REQUIREMENTS

MATERIAL COMPOSITION DATA MUST BE ENTERED INTO INTERNATIONAL MATERIAL DATA SYSTEM (IMDS) FOR NEAPCO INTERNAL DELIVERIES ONLY REQUESTED FROM FINAL ASSEMBLY PLANT TO OEM/TIERT

APPLICABLE CUSTOMER STANDARD TO HELP SAFEGUARD HEALTH, SAFETY AND THE ENVIRONMENT: ---

THIS DRAWING AND ANY INTELLECTUAL PROPERTY RIGHTS THEREIN ARE INTERNAL PROPERTY OF NEAPCO AND NO LICENSES ARE GRANTED UNDER THOSE RIGHTS			
<input checked="" type="checkbox"/> RFQ ONLY	DRAFTED IN ACCORDANCE WITH NEAPCO ENGINEERING CAD STANDARDS CURRENT AT INITIAL RELEASE	MUST COMPLY WITH NEAPCO AND APPLICABLE OEM RESTRICTED SUBSTANCE MANAGEMENT STANDARDS	
<input type="checkbox"/> FOR TOOLING	3RD ANGLE PROJ	DATA TYPE: CATIA V5 R28	DTMC IS MASTER
<input type="checkbox"/> PROTOTYPE			
<input type="checkbox"/> PRODUCTION			
SPECIFICATION TITLE		SCALE: 2 : 1	SHT 1 OF 1
BOOT IBJ TPe43		UNITS: mm	DWG FILE VERS: ---
ENOVIA PART NAME		CLI	PROTOTYPE IND
E0011262.A		-P	